

Courses & Distances

S 72½ W 107¾
 N 23 W 58
 N 83 E 114½
 S 19 E 37

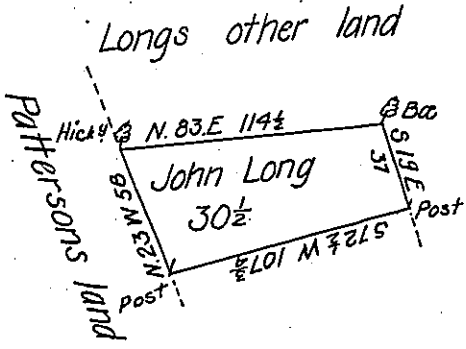

The Draught of a tract of land Situate in Greenwood township Cumber-
 land County containing Thirty acres & an half & the usual allowance of
 Six P^{ct} Cent for roads &c.^o Surveyed Jan^y the 17th 1786 for John Long in
 pursuance of a Warrant from The Honorable the Proprietaries Dated
~~May~~ ^{March} the 19th 1776

Ja^s Harris D.S.

John Lukens Esq^r.

IN TESTIMONY that the above is a copy of the original remaining on file in
 the Department of Internal Affairs of Pennsylvania, made
 conformably to an Act of Assembly approved the 16th day of
 February, 1833, I have hereunto set my Hand and caused
 the Seal of said Department to be affixed at Harrisburg,
 this.....14th.....day of.....July.....1905.

Loac R. Brown
 Secretary of Internal Affairs.